

Stribling

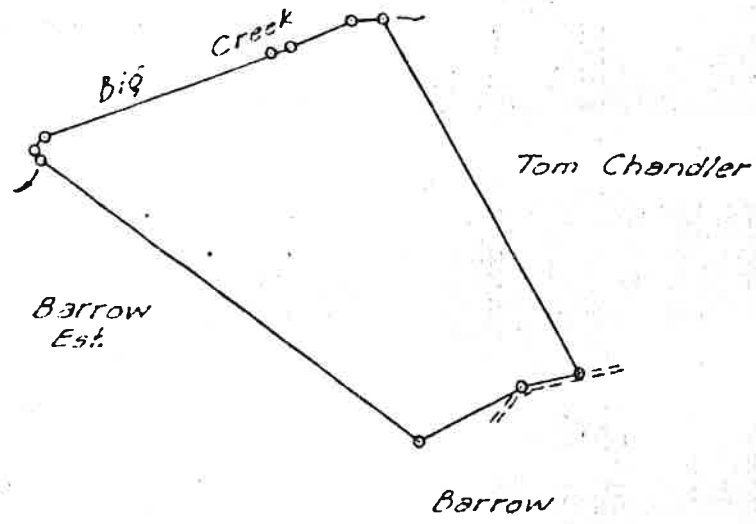

<u>Station</u>	<u>Bearing</u>	<u>Distance Chains</u>	<u>Description of Corner, etc.</u>
BEGINNING at stake in mound of rocks on north bank of county road			
1-2	N 29 30' W	41.41	Stake on south bank of Big Creek, Wit. 5" Ash S 48 W 18', 10" sweet gum S 88 E 18
2-3	S 82 00' W	3.13	
	S 65 45' W	6.61	
	S 61 00' W	1.71	
	S 67 15' W	25.17	
	S 31 45' W	1.31	
	S 20 30' E	.78	Stake on east bank of Big Creek, Wit. 10" Pine S 58 W 03; 8" Ash N 40 E 17.
3-4	S 53 30' E	48.36	Stake in mound of rocks center of old county road.
4-1	N 61 00' E	11.71	To Beginning
	N 65 00' E	6.31	